

# Attachment A4

<b>Reference Scheme</b>
-------------------------

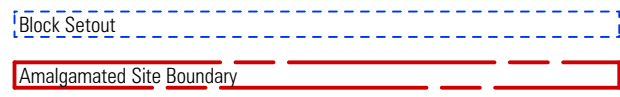

LEGEND

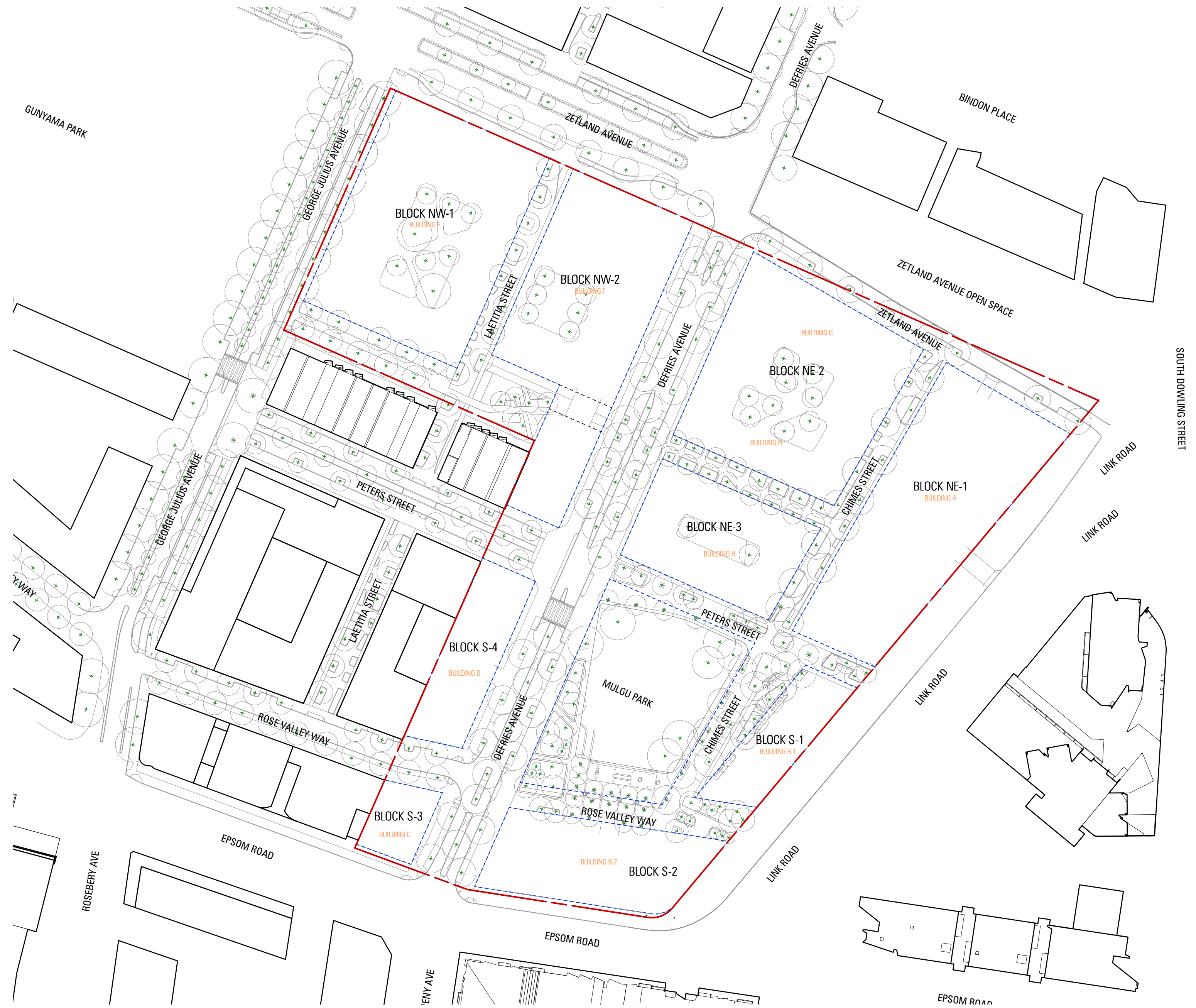
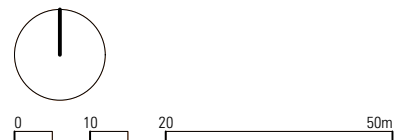

LEGEND

REVISIONS	DATE	UPDATED BY	MIX
A	16/6/2022		SUBMISSION 01
B	10/7/2022		SUBMISSION 01

**SITE LAYOUT**  
**2129A 10000 B**



LEGEND

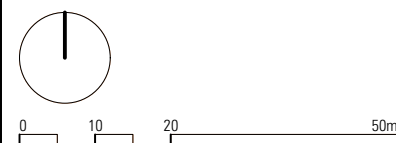

LEGEND

REVISIONS	UPDATED MIX
A 16/6/2022	SUBMISSION 01
B 10/7/2022	



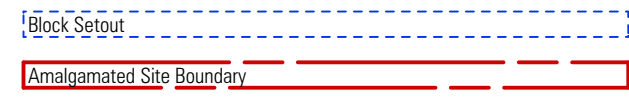
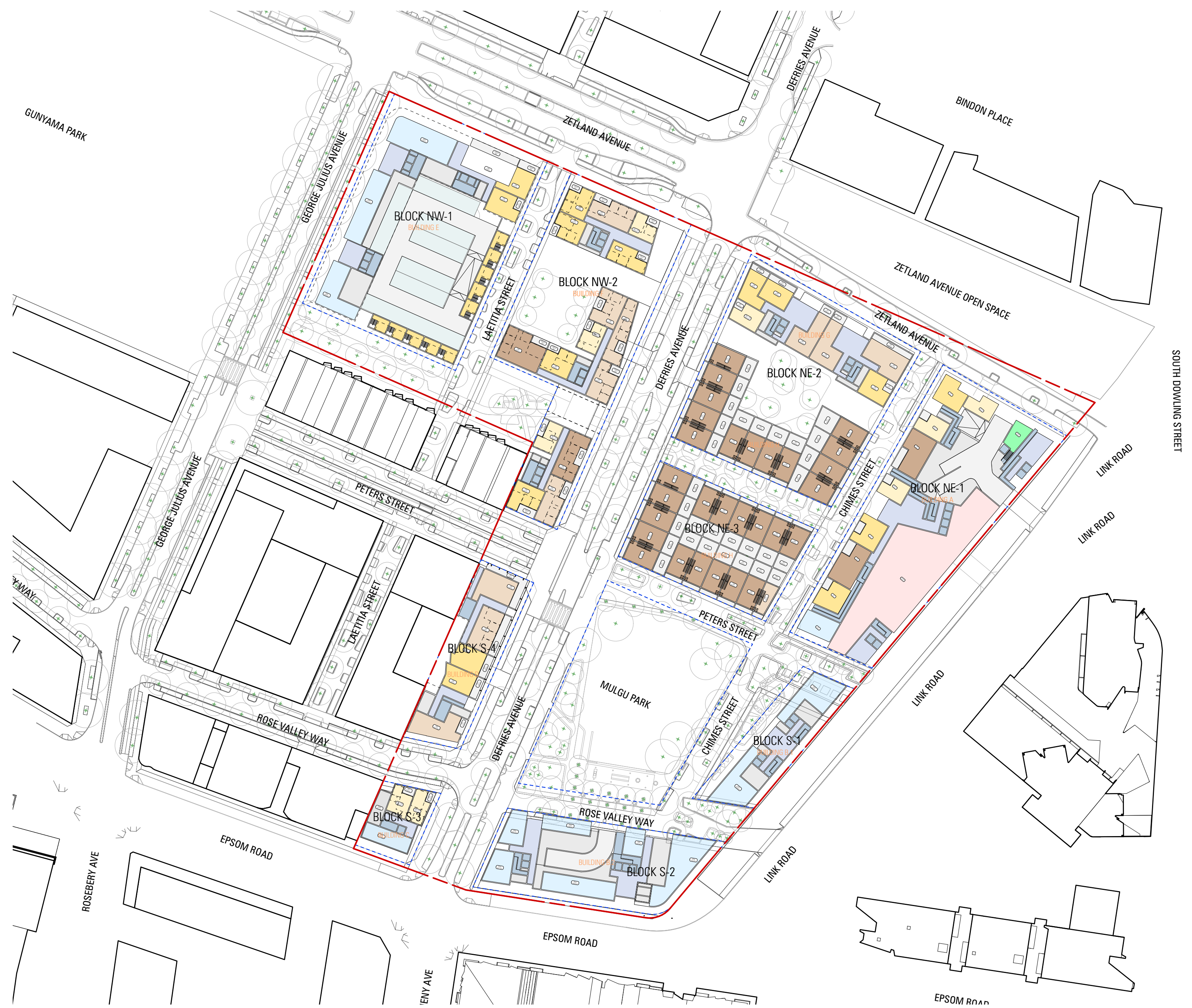

LEGEND

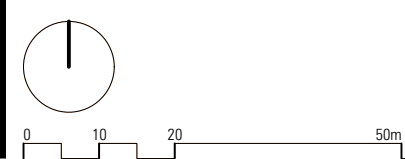

**MAKO ARCHITECTURE**  
 SUITE 108  
 59 MARLBOROUGH ST  
 SURRY HILLS NSW 2010  
 ARCH. REG. NO. 8886[NSW] 19020[VIC]  
 WWW.MAKOARCHITECTURE.COM.AU

STUDIO 5 LEVEL 1 BAILEYS ARCADE  
 131-157 LONDON CIRCUIT  
 CANBERRA CITY 2601  
 2569[ACT]

PROJECT DETAILS  
 SUTTON SITE  
 ZETLAND  
 by  
 MERITON

NOTES  
 all dimensions in millimetres unless otherwise noted  
 check all dimensions on site prior to construction  
 work to figured dimensions. do not scale off drawings

to be read in conjunction with the complete documentation package including, but not limited to, all consultant drawings, specifications, reports and consent conditions  
 report all discrepancies to the project manager

LEGEND

REVISIONS	UPDATED MIX	STATUS
A 16/6/2022	SUBMISSION 01	REFERENCE DESIGN
B 10/7/2022	SUBMISSION 01	DATE 10/7/2022

LEVEL 01\_GROUND  
 2129A 11002 B

2129\_REFERENCE SCHEME - COMPILED.vwx



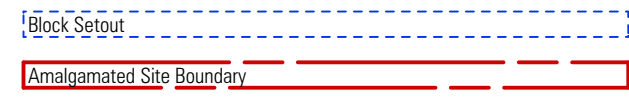

LEGEND

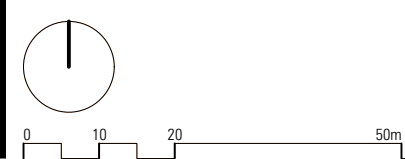

**MAKO ARCHITECTURE**  
 SUITE 108  
 59 MARLBOROUGH ST  
 SURRY HILLS NSW 2010  
 ARCH. REG. NO. 8886[NSW] 19020[VIC]  
 WWW.MAKOARCHITECTURE.COM.AU

STUDIO 5 LEVEL 1 BAILEYS ARCADE  
 131-157 LONDON CIRCUIT  
 CANBERRA CITY 2601  
 2569[ACT]

PROJECT DETAILS  
 SUTTON SITE  
 ZETLAND  
 by  
 MERITON

NOTES  
 all dimensions in millimetres unless otherwise noted  
 check all dimensions on site prior to construction  
 work to figured dimensions. do not scale off drawings

to be read in conjunction with the complete documentation package including, but not limited to, all consultant drawings, specifications, reports and consent conditions  
 report all discrepancies to the project manager

LEGEND

REVISIONS	DATE	UPDATED MIX	SUBMISSION 01
A	16/6/2022		
B	10/7/2022		

TYPICAL LEVELS 02-04  
 2129 A 11003 B

STATUS  
**REFERENCE DESIGN**  
 DATE  
 10/7/2022  
 2129\_REFERENCE SCHEME - COMPILED.vwx



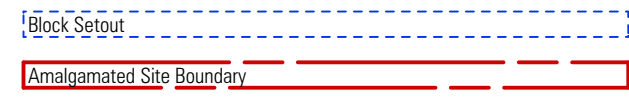

LEGEND

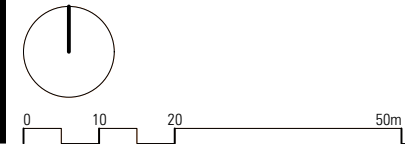

**MAKO ARCHITECTURE**  
 SUITE 108  
 59 MARLBOROUGH ST  
 SURRY HILLS NSW 2010  
 ARCH. REG. NO. 8886[NSW] 19020[VIC]  
 WWW.MAKOARCHITECTURE.COM.AU

STUDIO 5 LEVEL 1 BAILEYS ARCADE  
 131-157 LONDON CIRCUIT  
 CANBERRA CITY 2601  
 2569[ACT]

PROJECT DETAILS  
 SUTTON SITE  
 ZETLAND  
 by  
 MERITON

NOTES  
 all dimensions in millimetres unless otherwise noted  
 check all dimensions on site prior to construction  
 work to figured dimensions. do not scale off drawings

to be read in conjunction with the complete documentation package including, but not limited to, all consultant drawings, specifications, reports and consent conditions  
 report all discrepancies to the project manager

LEGEND

REVISIONS	DATE	UPDATED MIX	SUBMISSION 01
A	16/6/2022		
B	10/7/2022		

TYPICAL LEVELS 05-09  
 2129 A 11004 B

REFERENCE DESIGN  
 STATUS  
 DATE  
 10/7/2022  
 2129\_REFERENCE SCHEME - COMPILED.vwx



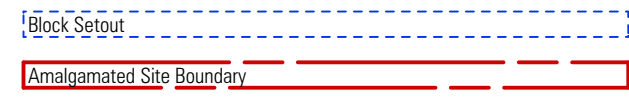
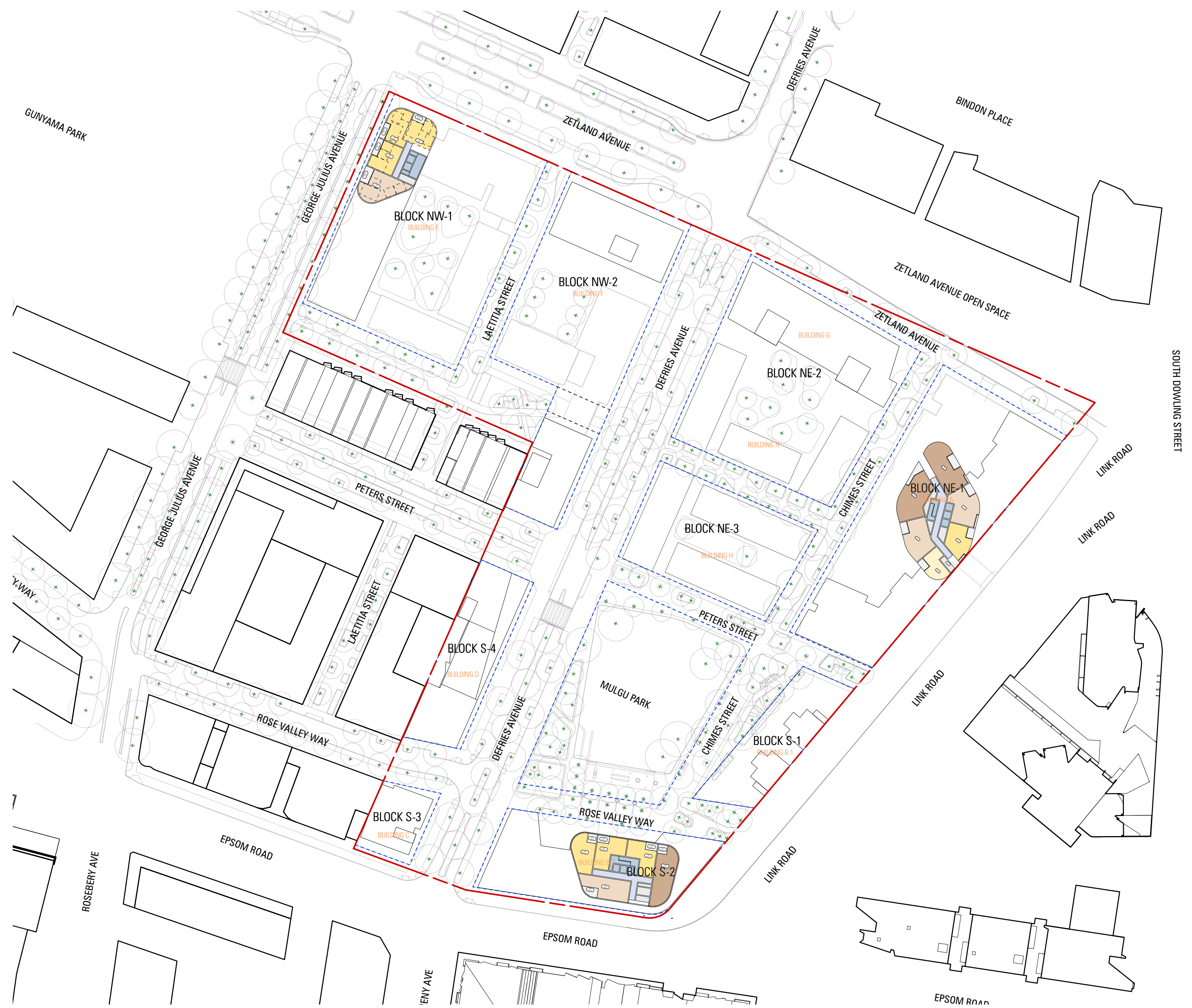

LEGEND

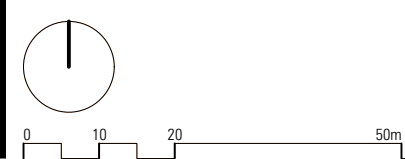

**MAKO ARCHITECTURE**  
 SUITE 108  
 59 MARLBOROUGH ST  
 SURRY HILLS NSW 2010  
 ARCH. REG. NO. 8886[NSW] 19020[VIC]  
 WWW.MAKOARCHITECTURE.COM.AU

STUDIO 5 LEVEL 1 BAILEYS ARCADE  
 131-157 LONDON CIRCUIT  
 CANBERRA CITY 2601  
 2569[ACT]

PROJECT DETAILS  
 SUTTON SITE  
 ZETLAND

for  
 MERITON

NOTES  
 all dimensions in millimetres unless otherwise noted  
 check all dimensions on site prior to construction  
 work to figured dimensions. do not scale off drawings

to be read in conjunction with the complete documentation package including, but not limited to, all consultant drawings, specifications, reports and consent conditions  
 report all discrepancies to the project manager

LEGEND

REVISIONS	DATE	UPDATED MIX	SUBMISSION
A	16/6/2022		
B	10/7/2022		SUBMISSION 01

TYPICAL LEVELS - TOWERS  
 2129 A 11005 B

STATUS  
**REFERENCE DESIGN**  
 DATE  
 10/7/2022  
 2129\_REFERENCE SCHEME - COMPILED.vwx

BLOCK S-1

Table with columns: 1 Bed, 1 Bed + Study, 2 Bed, 3 Bed, 4 Bed, TOTAL, GFA, NSA, Natural Vent, Solar Access 2hr, PARKING. Rows include LEVEL 08 to GROUND - LEVEL 01 and summary rows.

BLOCK NW-2

Table with columns: 1 Bed, 1 Bed + Study, 2 Bed, 3 Bed, 4 Bed, TOTAL, GFA, NSA, Natural Vent, Solar Access 2hr, PARKING. Rows include LEVEL 08 to GROUND - LEVEL 01 and summary rows.

BLOCK S-2 - PODIUM + TOWER

Table with columns: 1 Bed, 1 Bed + Study, 2 Bed, 3 Bed, 4 Bed, TOTAL, GFA, NSA, Natural Vent, Solar Access 2hr, PARKING. Rows include LEVEL 14 to GROUND - LEVEL 01 and summary rows.

BLOCK NE-1 - PODIUM + TOWER

Table with columns: 1 Bed, 1 Bed + Study, 2 Bed, 3 Bed, 4 Bed, TOTAL, GFA, NSA, Natural Vent, Solar Access 2hr, PARKING. Rows include LEVEL 23 to GROUND - LEVEL 01 and summary rows.

BLOCK S-3

Table with columns: 18+ MPH, TOTAL, GFA, NSA, Natural Vent, Solar Access 2hr, PARKING. Rows include LEVEL 07 to GROUND - LEVEL 01 and summary rows.

BLOCK S-4

Table with columns: 1 Bed, 1 Bed + Study, 2 Bed, 3 Bed, 4 Bed, TOTAL, GFA, NSA, Natural Vent, Solar Access 2hr, PARKING. Rows include LEVEL 08 to GROUND - LEVEL 01 and summary rows.

BLOCK NW-1 - PODIUM + TOWER

Table with columns: 1 Bed, 1 Bed + Study, 2 Bed, 3 Bed, 4 Bed, TOTAL, GFA, NSA, Natural Vent, Solar Access 2hr, PARKING. Rows include LEVEL 14 to GROUND - LEVEL 01 and summary rows.

BLOCK NE-2

Table with columns: 1 Bed, 1 Bed + Study, 2 Bed, 3 Bed, 4 Bed, TOTAL, GFA, NSA, Natural Vent, Solar Access 2hr, PARKING. Rows include LEVEL 08 to GROUND - LEVEL 01 and summary rows.

BLOCK NE-3 - TOWN HOMES

Table with columns: 1 Bed, 1 Bed + Study, 2 Bed, 3 Bed, 4 Bed, TOTAL / FLR, GFA, NSA, Natural Vent, Solar Access 2hr, PARKING. Rows include LEVEL 03 to TOWN HOMES - LEVEL 01 and summary rows.

Summary table with columns: RESI - APARTMENTS, BH Rooms, 1 Bed, 1 Bed + Study, 2 Bed, 3 Bed, 4 Bed, TOTAL, GFA, RETAIL, ELC. Rows include BLOCK NE-2, BLOCK NW-2, BLOCK NW-1, BLOCK S-4, BLOCK S-3, BLOCK S-2, BLOCK S-1 and summary rows.

Summary table with columns: RESI - TOWNHOUSE, BH Rooms, 1 Bed, 1 Bed + Study, 2 Bed, 3 Bed, 4 Bed, TOTAL, GFA, RETAIL, ELC. Rows include BLOCK NE-3 and summary rows.

FSR: 2.20 -1

SUMMARY